

Rear

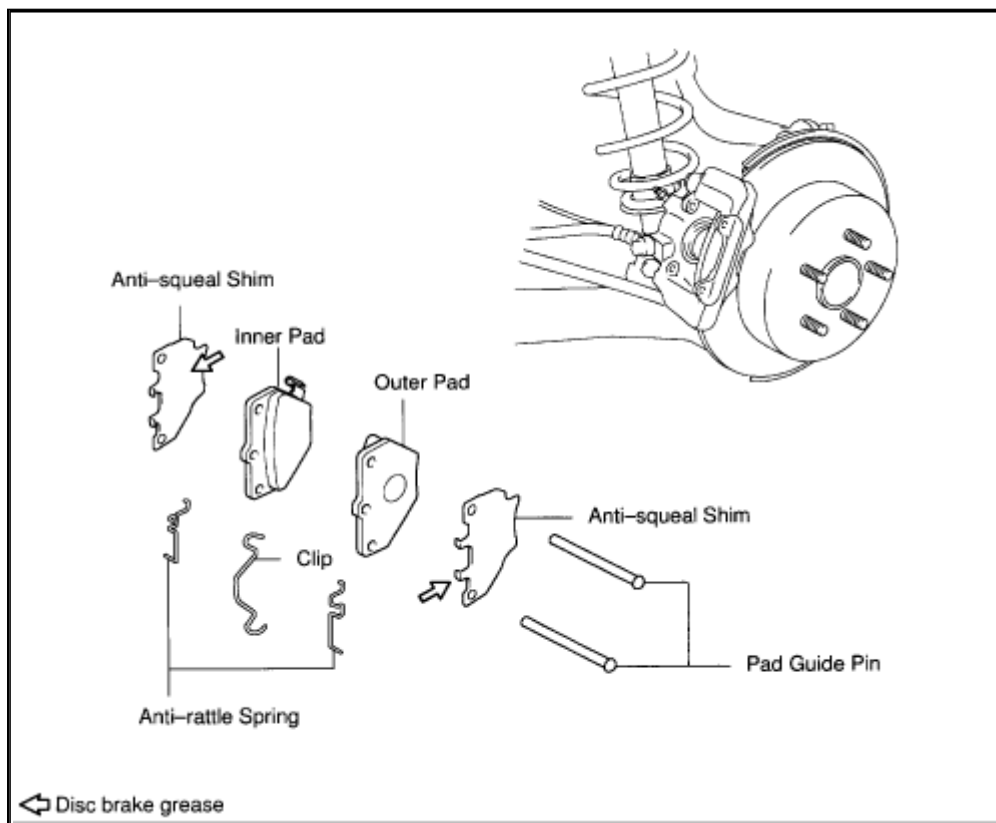

ZOOM

SIZED FOR PRINT

REPLACEMENT

1. REMOVE REAR WHEEL

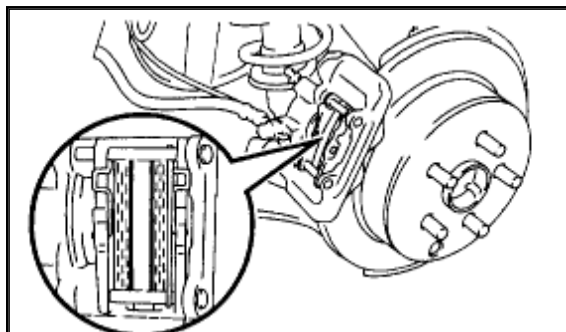

ZOOM

SIZED FOR PRINT

2. INSPECT PAD LINING THICKNESS Check the pad thickness. Minimum thickness: **1.0 mm (0.039 inch)**



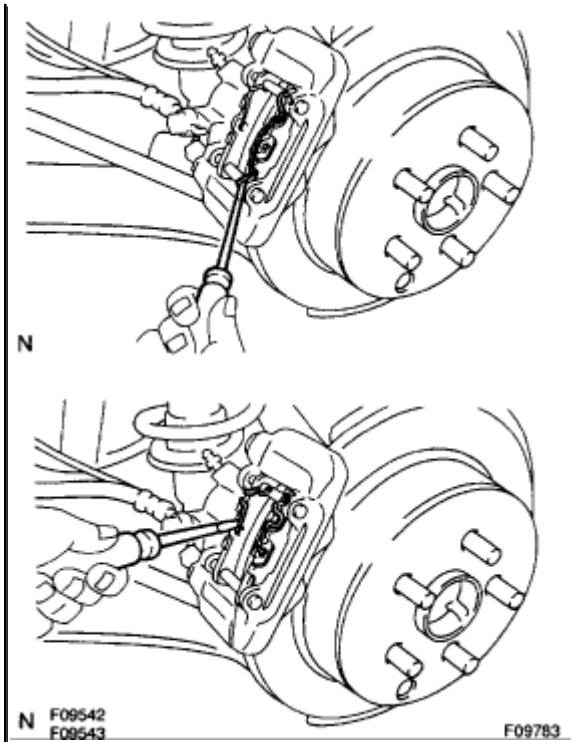

ZOOM

SIZED FOR PRINT

3. REMOVE CLIP, 2 ANTI-RATTLE SPRINGS AND 2 PAD GUIDE PINS

- a. Using a screwdriver, remove the clip and 2 anti-rattle springs. **NOTICE:**
 - o Do not deform the clip and anti-rattle spring.
 - o The clip and anti-rattle spring can be used again provided that they have sufficient rebound, no deformation, cracks or wear, and have had all rust, dirt and foreign particles cleaned off.
- b. Remove the 2 pad guide pins.

4. REMOVE PADS AND ANTI-SQUEAL SHIMS

- a. Remove the 2 pads.
- b. Remove the anti-squeal shim from each pad.

5. CHECK DISC THICKNESS AND RUNOUT

6. INSTALL NEW PADS **NOTICE:** When replacing worn pads, the anti-squeal shims must be replaced together with the pads.

- a. Apply disc brake grease to inside of anti-squeal shims.
- b. Install the anti-squeal shim on each pad.
- c. Draw out a small amount of [brake fluid](#) from the reservoir.



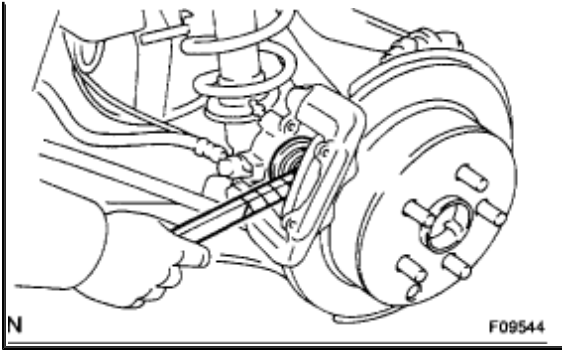

ZOOM

SIZED FOR PRINT

- d. Press in the piston with a hammer handle or equivalent. **HINT:** Tape the hammer handle before use. If the piston is difficult to push in, loosen the bleeder plug and push in the piston while letting some [brake fluid](#) escape.
- e. Install the inner pad with the pad wear indicator plates facing upward, and install the outer pad. **NOTICE:** There should be no oil or grease adhering to the friction surfaces of the pads and the disc.

7. INSTALL 2 PAD GUIDE PINS, 2 ANTI-RATTLE SPRINGS AND CLIP

- a. Install the 2 anti-rattle springs on the each pad.

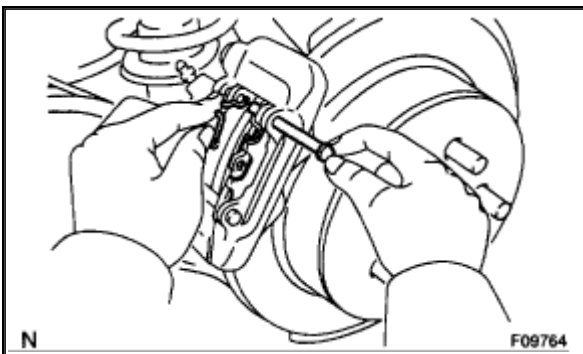

ZOOM

SIZED FOR PRINT

- b. While pressing the anti-rattle spring, and install the pad guide pin.
- c. Install the clip to the pad guide pin.

8. INSTALL REAR WHEEL Torque: **103 Nm (1,050 kgf-cm, 76 ft. lbs.)**
9. DEPRESS BRAKE PEDAL SEVERAL TIMES
10. CHECK THAT FLUID LEVEL IS AT MAX LINE